

**DJK - STRAIGHT RESIN JOINTING KITS**

**Kit Contents:**

- 1 x Insulated Power Cable
- 1 x Plastic Shell
- 1 x 2-Component Cast-Resin
- 1 x Sandcloth Paper
- 1 x PVC Tape
- 2 x Constant Force Spring
- 1 x Installation Instructions



Please note, this product may only be installed by trained specialised personnel.

**DJK1 also contains:**

- 4 x 4mm<sup>2</sup> Butt Splices
- 4 x 6mm<sup>2</sup> Butt Splices
- 4 x 10mm<sup>2</sup> Butt Splices
- 4 x 16mm<sup>2</sup> Butt Splices



**OTHER ADDITIONAL INFORMATION**

Size	Cable Size (mm <sup>2</sup> ) For 4 armoured cable	d1 (mm)	d2 (mm)	L (mm)	D (mm)	H (mm)
M11	4 x 4-6	15	23	190	36	50
M13	4 x 16-35	21	43	360	55	75
M15	4 x 70-120	35	63	530	100	120

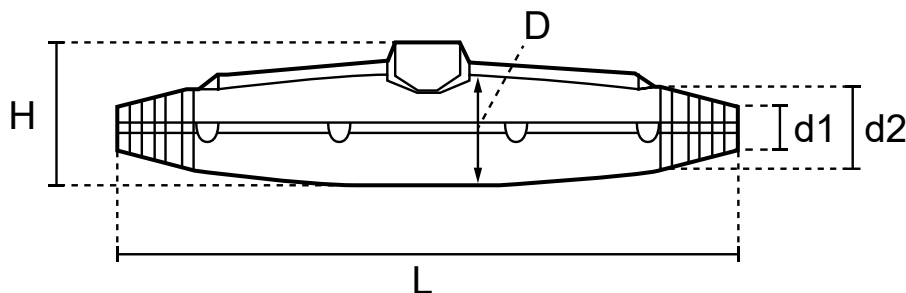

**For cable conversion chart, please see next page.**

Code	No. Cores	Conductor Size (mm)	Cable Diameter (mm)	Cable Entry Min/Max. (mm)	Working Room Min/Max. (mm)	Connectors Included
-	2	1.5	12.10			-
-	3	1.5	12.60			-
-	4	1.5	13.50			-
-	2	2.5	13.60			-
-	3	2.5	14.10			-
DJK1	4	2.5	15.00	M11 (15-23)	36	4 x 4mm <sup>2</sup> / 4 x 6mm <sup>2</sup> / 4 x 10mm <sup>2</sup> / 4 x 16mm <sup>2</sup>
-	2	4	14.70			-
DJK1	3	4	15.30	M11 (15-23)	36	4 x 4mm <sup>2</sup> / 4 x 6mm <sup>2</sup> / 4 x 10mm <sup>2</sup> / 4 x 16mm <sup>2</sup>
DJK1	4	4	16.40	M11 (15-23)	36	4 x 4mm <sup>2</sup> / 4 x 6mm <sup>2</sup> / 4 x 10mm <sup>2</sup> / 4 x 16mm <sup>2</sup>
DJK1	2	6	15.90	M11 (15-23)	36	4 x 4mm <sup>2</sup> / 4 x 6mm <sup>2</sup> / 4 x 10mm <sup>2</sup> / 4 x 16mm <sup>2</sup>
DJK1	3	6	16.60	M11 (15-23)	36	4 x 4mm <sup>2</sup> / 4 x 6mm <sup>2</sup> / 4 x 10mm <sup>2</sup> / 4 x 16mm <sup>2</sup>
DJK1	4	6	18.70	M11 (15-23)	36	4 x 4mm <sup>2</sup> / 4 x 6mm <sup>2</sup> / 4 x 10mm <sup>2</sup> / 4 x 16mm <sup>2</sup>
DJK1	2	10	18.00	M11 (15-23)	36	4 x 4mm <sup>2</sup> / 4 x 6mm <sup>2</sup> / 4 x 10mm <sup>2</sup> / 4 x 16mm <sup>2</sup>
DJK1	3	10	19.50	M11 (15-23)	36	4 x 4mm <sup>2</sup> / 4 x 6mm <sup>2</sup> / 4 x 10mm <sup>2</sup> / 4 x 16mm <sup>2</sup>
DJK1	4	10	21.10	M11 (15-23)	36	4 x 4mm <sup>2</sup> / 4 x 6mm <sup>2</sup> / 4 x 10mm <sup>2</sup> / 4 x 16mm <sup>2</sup>
DJK1	2	16	20.40	M11 (15-23)	36	4 x 4mm <sup>2</sup> / 4 x 6mm <sup>2</sup> / 4 x 10mm <sup>2</sup> / 4 x 16mm <sup>2</sup>
DJK1	3	16	21.60	M11 (15-23)	36	4 x 4mm <sup>2</sup> / 4 x 6mm <sup>2</sup> / 4 x 10mm <sup>2</sup> / 4 x 16mm <sup>2</sup>
DJK1	4	16	22.90	M11 (15-23)	36	4 x 4mm <sup>2</sup> / 4 x 6mm <sup>2</sup> / 4 x 10mm <sup>2</sup> / 4 x 16mm <sup>2</sup>
DJK2	2	25	24.10	M13 (21-43)	55	Connectors Available Separately
DJK2	3	25	25.50	M13 (21-43)	55	Connectors Available Separately
DJK2	4	25	27.60	M13 (21-43)	55	Connectors Available Separately
DJK2	2	35	23.30	M13 (21-43)	55	Connectors Available Separately
DJK2	3	35	28.00	M13 (21-43)	55	Connectors Available Separately
DJK2	4	35	30.40	M13 (21-43)	55	Connectors Available Separately
DJK2	2	50	25.80	M13 (21-43)	55	Connectors Available Separately
DJK2	3	50	28.50	M13 (21-43)	55	Connectors Available Separately
DJK2	4	50	32.00	M13 (21-43)	55	Connectors Available Separately
DJK2	2	70	29.00	M13 (21-43)	55	Connectors Available Separately
DJK2	3	70	32.20	M13 (21-43)	55	Connectors Available Separately
DJK2	4	70	37.70	M13 (21-43)	55	Connectors Available Separately
DJK2	2	95	33.10	M13 (21-43)	55	Connectors Available Separately
DJK2	3	95	37.00	M13 (21-43)	55	Connectors Available Separately
DJK2	4	95	41.70	M13 (21-43)	55	Connectors Available Separately
DJK2	2	120	36.10	M13 (21-43)	55	Connectors Available Separately
DJK2	3	120	40.40	M13 (21-43)	55	Connectors Available Separately
DJK3	4	120	47.10	M15 (35-63)	100	Connectors Available Separately
DJK3	2	150	39.30	M15 (35-63)	100	Connectors Available Separately
DJK3	3	150	45.50	M15 (35-63)	100	Connectors Available Separately
DJK3	4	150	51.40	M15 (35-63)	100	Connectors Available Separately
DJK3	2	185	44.70	M15 (35-63)	100	Connectors Available Separately
DJK3	3	185	49.80	M15 (35-63)	100	Connectors Available Separately
DJK3	4	185	56.60	M15 (35-63)	100	Connectors Available Separately
DJK3	2	240	49.00	M15 (35-63)	100	Connectors Available Separately
DJK3	3	240	55.10	M15 (35-63)	100	Connectors Available Separately
DJK3	4	240	63.00	M15 (35-63)	100	Connectors Available Separately
DJK3	2	300	53.50	M15 (35-63)	100	Connectors Available Separately
DJK3	3	300	60.20	M15 (35-63)	100	Connectors Available Separately
-	4	300	68.80			-
DJK3	2	400	59.00	M15 (35-63)	100	Connectors Available Separately
-	3	400	66.60			-
-	4	400	78.10			-

\*Cable sizes for reference only

\*\*Actual cable sizes should be checked before order due to tolerance differences in manufacture

\*\*\* Cable size source DEW – SWA cable (steel wired armoured) BS5467