

# DROP-IN ANCHOR

# DELIGO SPECIFICATIONS

Safe Working Load kN Tested in 200 - 250<sup>o</sup> Concr

	PULL OUT LOAD		ULTIMATE LOAD 30N/mm	
	TENSILE (kN)	SHEAR (kN)	0 <sup>o</sup> TENSILE	90 <sup>o</sup>
M6	2.37	2.0	10.00	7.8
M8	3.37	3.2	15.2	13.9
M10	4.87	5.0	18.3	21.0
M12	7.25	7.9	27.8	32.5
M16	12.12	16.4	38.5	61.7
M20	14.75	23.0	60.2	97.1

Drill required hole to stated minimum embedment depth. Increase depth to suit longer bolts.

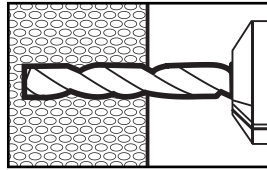

Brush and blow out hole. Insert anchor.

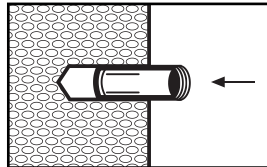

Tap home avoiding damage to threads.

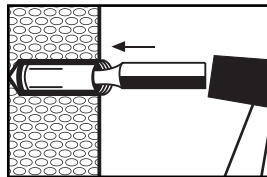

Expand using the setting\* and hammer until the shoulder of the tool is flush with the anchor.

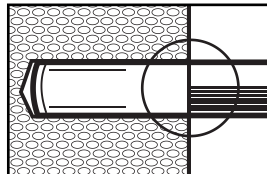

\*Ensure correct size setting tool is used.

Place fixture and insert bolt (or threaded rod) and tighten bolt. Do not exceed the maximum torque, irrespective of bolt grade. Do not allow thread to bottom in anchor

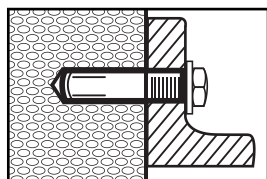

## Specifications

DAM - Drop in Anchor

SUITABLE FOR:

The Drop in Anchor is internally threaded to offer a suitable fixing in conjunction with all standard types of metric bolts, set screws and studding.

The Drop in Anchor creates a strong permanent and reusable female thread in the base material.

## Material Specification

Anchor Material

C1008 or C1015 Mild Steel

Plating

Zinc Plate/Yellow Passivate - 3 Microns

## Applications

SUSPENDED SERVICES

Pipe work, duct work, sprinkler systems, cable trays, ceilings.

METAL WORK

Bracketry, holding down machinery, racking, stadium seating.

PRODUCT CODE	ANCHOR DIA x LENGTH	DRILL DIA (mm)	SCREW TO BE INSERTED mm	MIN HOLE DEPTH mm	SETTING TOOL CODE
IASM6	8 x 25	8	12	25/40	ISTM6
IASM8	10 x 30	10	14	30/40	ISTM8
IAS10	12 dia x 40	12	18	40	ISTM10
IASM12	15 dia x 50	15	21	50	ISTM12
IASM16	20 dia x 62	20	25	62	25 dia x
80	25	34	80	DAST620	